

# CUSTOM DOOR PANELS SPECIFICATIONS

FOR BUILT-IN REFRIGERATOR MODEL RBM75S5FPNS

Panels to be manufactured and fitted by cabinet maker and installer

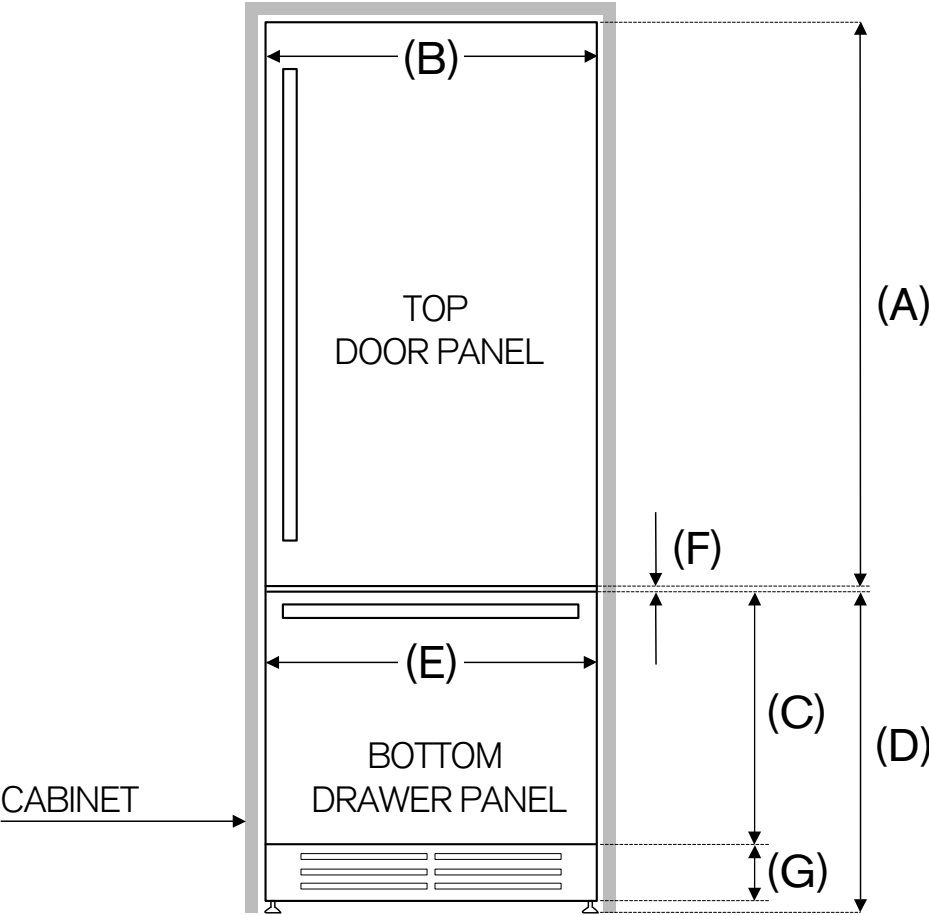

**NOTE:** These specifications assume a standard toe kick height of 100 mm. For different toe kick heights, adjust C accordingly.

DIMENSIONS - MILLIMETERS		
(A)	Height of top door panel	1297 mm
(B)	Width of top door panel	756 mm
(C)	Height of bottom drawer panel	729 mm
(D)	Height from bottom of product to top of bottom drawer panel	830 mm
(E)	Width of bottom drawer panel	756 mm
(F)	Gap between top door panel and bottom drawer panel	3 mm
(G)	Toe kick height	100 mm
(A+F+D)	Overall height	2123 mm
Thickness of custom panels		min 19 - max 38 mm

WEIGHT - KILOGRAMS	
Maximum weight of top door panel	16 kg
Maximum weight of bottom drawer panel	9 kg

**Disclaimer:** while every effort has been made to insure the accuracy of the information contained in this document, Fratelli Bertazzoni reserves the right to change any part of the information at any time without notice. For detailed installation specifications consult the installation manual. Fratelli Bertazzoni, Bertazzoni and the winged wheel brand icon are registered trademarks of Bertazzoni Spa.